

Dismantle original front fender

1. Loosen the screws (2) of the upper bracket (9).
2. Remove the bracket and fender

Fitting the "Custom" front fender

1. The front fender is mounted to the metal bracket attachment on the motorbike. Replace the screws (2) with the screws supplied (4x DIN7984 M8x45).
2. Add washers (4x ISO7091 M8) between the front fender (inside) and the nuts (4x ISO4032 M8) and tighten the bolts and nuts.
Tightening torque: 15 to 20Nm

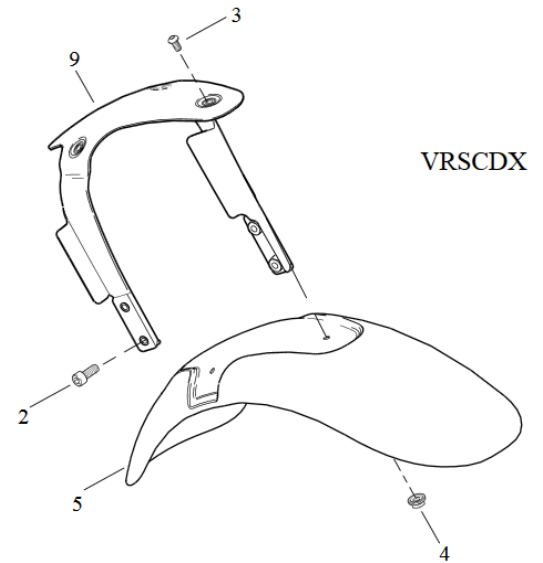

When mounting, ensure sufficient clearance to moving parts.

We recommend using a medium-strength screw lock (e.g. LOCTITE 243, blue) for all screws.



Abb. 1 - Mounted front fender



Abb. 2 – front fender "Custom"