

Dismantle original front fender

1. loosen the screws (13) and remove the original front fender (21).

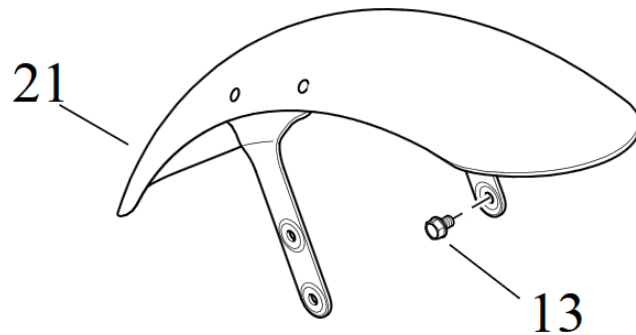

Fitting the "Custom" front fender

1. mount the front fender to the motorbike with the screws (13).
Tightening torque: 15 to 20Nm

When mounting, ensure a central position (above the tyre) and sufficient clearance to moving parts.

We recommend using a medium-strength screw lock (e.g. LOCTITE 243, blue) for all screws.



Abb. 1 - Mounted front fender



Abb. 2 - Front fender "Custom" V1