

Dismantle original front fender

1. Loosen the screws (14) and remove the original front fender (19) including all associated parts

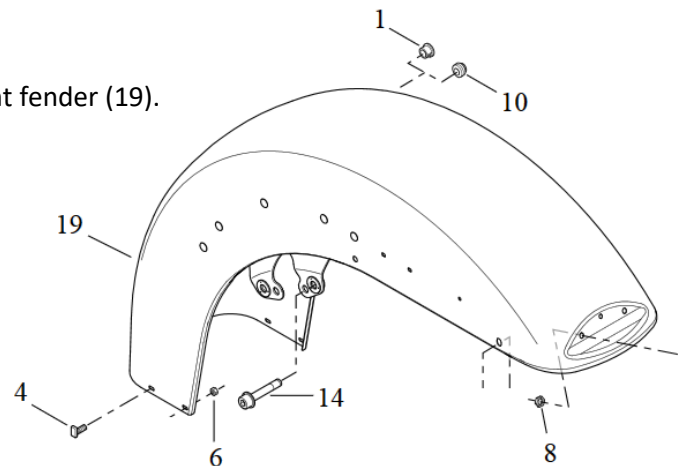

Fitting the "Custom" front fender

The front fender is mounted on the original attachment

1. replace the screws (14) with the screws supplied (ISO4762 M8x45).
2. put washers (ISO7092 M8) between the fender (inside) and the nuts (ISO4032 M8).
3. tighten nuts and bolts
Tightening torque: 15 to 20Nm

When mounting, ensure a central position (above the tyre) and sufficient clearance to moving parts.

We recommend using a medium-strength screw lock (e.g. LOCTITE 243, blue) for all screws.



Abb. 1 - mounted front fender



Abb. 2 – front fender "Custom" V2